

Omnex Sani-Fit

Technical drawing

The omnex Sani-Fit is compatible with the most commonly used wall-hung toilet systems on the market. Dimensions on the technical drawing.

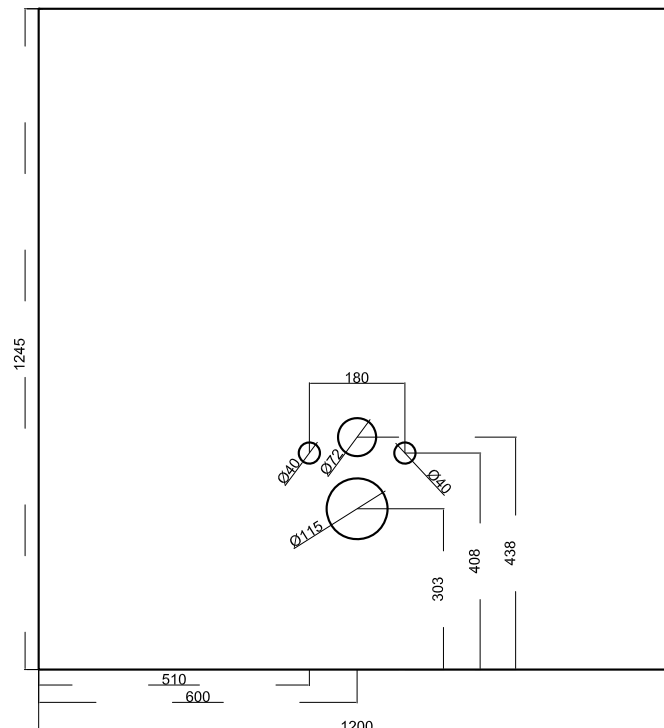

Necessary materials:

- Omnex Sani-Fit plate with ten stainless steel Omnex screws supplied.
- Polymer glue (Tec7 X-Tack or equivalent)
- Self-adhesive fiberglass tape

Step-by-step plan :

1. Cut the Omnex Sani-Fit plate to the desired size. This can easily be done with a utility knife or a circular saw. Sand the broken edges with a sanding block for even slab joints.

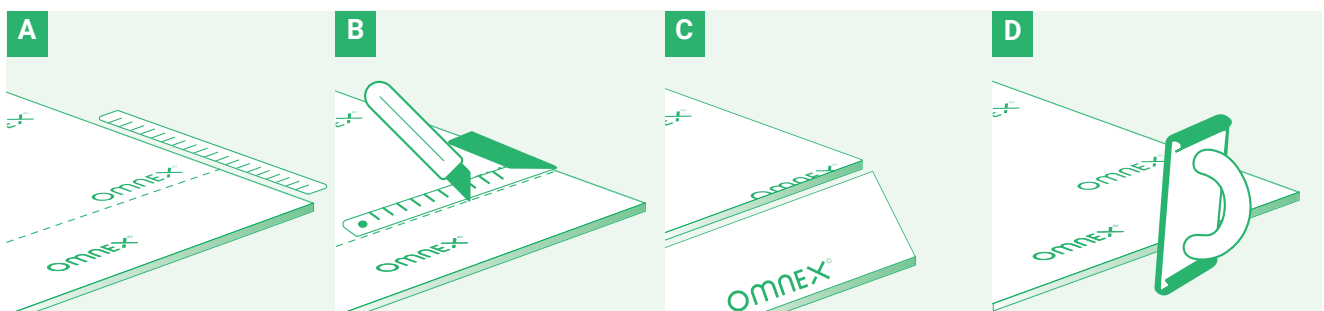

2. You need to make a whole for the control panel.
Saw these out carefully with a tilting saw.



3. Spray the glue all over the frame both vertically and horizontally.

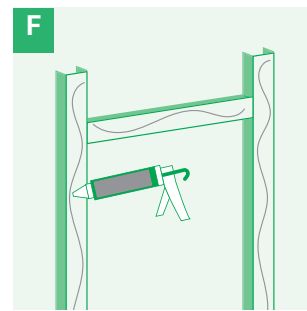

4. Fix the Omnex Sani-Fit panel with the Omnex screws every 200mm on both sides.

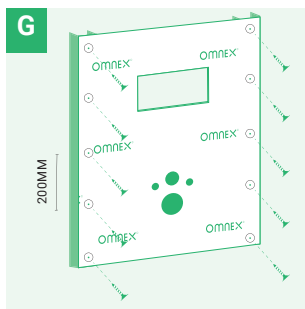

5. You can use cut strips to finish your toilet installation above and on the sides. Reinforce the corner joints and the joint between the wall and floor covering with self-adhesive fiberglass tape.



6. The finishing with tiles, mosaic and / or plaster can be done directly without any pre-treatment. Wait at least 24 hours (in accordance with the guidelines of the glue manufacturer) before attaching the toilet to the system.

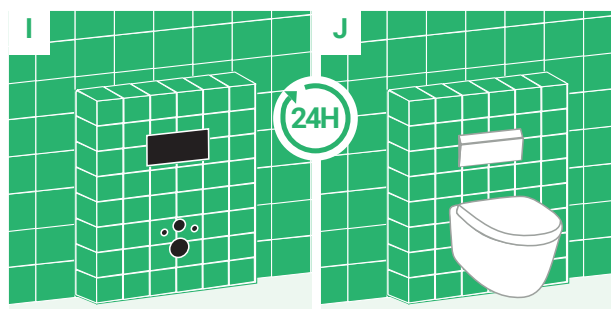

With Omnex Sani-Fit you gain time and comfort!

latest version: 18/01/2021

Omnex
Avenue Alexander Fleming 1
1348 Ottignies-Louvain-la-Neuve
Belgium

E info@omnex-panels.com T +32 10 81 09 56

www.omnex-panels.com